

\$499,000 - 56318 Hwy 28, Rural Sturgeon County

MLS® #E4416162

\$499,000

0 Bedroom, 0.00 Bathroom,
Rural on 68.00 Acres

None, Rural Sturgeon County, AB

Prime +/-68 Acres Agricultural Land with Highway 28 Frontage. This exceptional +/-68 Acres parcel offers a rare opportunity in a highly desirable location, just 5 minutes from Gibbons and 40 minutes to Edmonton. Situated at the SW corner of Township Road 564 and Highway 28, this property boasts premium visibility and accessibility, making it an ideal investment for land banking or agricultural ventures. Zoned for agriculture, the land is well-suited for farming operations, with its expansive open space and strategic positioning. Its Highway 28 frontage ensures convenience and potential for future growth in an area that's steadily developing. Whether you're looking to expand your farming portfolio, secure a valuable investment, or explore future possibilities, this property delivers unmatched potential. Don't miss this chance to own a versatile piece of land in a sought-after area!

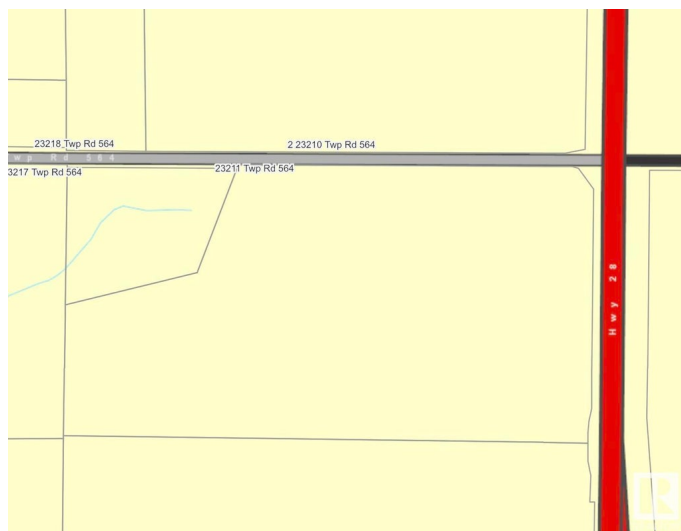

Essential Information

MLS® #	E4416162
Price	\$499,000
Bathrooms	0.00
Acres	68.00
Type	Rural
Sub-Type	Vacant Lot/Land

Status Active

Community Information

Address 56318 Hwy 28
Area Rural Sturgeon County
Subdivision None
City Rural Sturgeon County
County ALBERTA
Province AB
Postal Code T0A 1N4

Exterior

Exterior Features Rolling Land

Additional Information

Date Listed December 16th, 2024
Days on Market 126
Zoning Zone 60

DATA IS DEEMED RELIABLE BUT IS NOT GUARANTEED ACCURATE BY THE REALTORS® ASSOCIATION OF EDMONTON. COPYRIGHT 2025 BY THE REALTORS® ASSOCIATION OF EDMONTON. ALL RIGHTS RESERVED.Trademarks are owned or controlled by the Canadian Real Estate Association (CREA) and identify real estate professionals who are members of CREA (REALTOR®, REALTORS®) and/or the quality of services they provide (MLS®, Multiple Listing Service®)
Listing information last updated on April 21st, 2025 at 4:32am MDT